



# LED Integrated Mariner - Standard

LED IP65 IK08 CLASS I CE UK CA

## Product information

This fixture has a simple but attractive design, that makes it suitable for applications in commercial, residential or industrial environments. It is an energy-efficient, long-life, low maintenance alternative to traditional fluorescent waterproof fixtures.

## Features

- High performance with 6 lumen packages – up to 121 lm/W
- 50 000 hours lifetime (L80B10)
- 2 color temperatures: 4000 and 6500K with SDCM < 6
- Color rendering index: CRI > 80
- Linear luminaire with high ingress protection rating (IP65) and high impact resistance (IK08)
- Suitable for operation in ambient temperature of -20°C to +40°C
- Integrated through-wiring 3x1.0mm<sup>2</sup>
- Easy connection solution on both ends of the fixture allow continuous installations
- Samsung LED chip
- Static built-in driver
- Power factor: 0.5
- Supply Voltage: 220-240V, 50/60Hz
- High (850°C) Glow wire temperature
- Cannot be used in corrosive environment

## Application areas



Industrial



Car park /  
Garages



Retail

## Structures and materials

- Impact-resistant, polycarbonate housing and cover
- UV stabilized, flame retardant polycarbonate with improved light transmission and good color stability under heat exposure
- Colour: grey
- Convenient assembly bracket for ceiling mount, also opportunities for wall mounting with metal parts
- Small size profile and lightweight design
- All accessories for installation are included in the package: 2pcs wall mount clips plus 4pcs of screws
- Cable entry size D=6-9mm
- Continuous connection up to 10pcs, depending on the circuit breakers
- Wall mounting accessories are made of stainless steel

# Specification summary

Parameters below are the same for all luminaires in the range:

Light Technology used	LED	Input Voltage & Frequency	220-240V
Light source	Non-replaceable light source	Power factor	>0.5
Mains / Non-mains	Mains Light source	Displacement factor	>0.85 or >0.95
Directional / Non-directional	Non-directional	Standby power	NA
Colour-tuneable	No	Lifetime (L80B10)	50
Anti-glare shield	No	Survival factor at 3000h	1
Correlated color temperature (CCT)	4000K / 6500K	Lumen maintenance at 3000h	96%
Colour rendering index (CRI) (Ra) min	80	Ingress protection (IP)	IP65
R9 colour rendering index value	NA	Impact protection (IK)	IK08
SDCM (Standard Deviation or Color Maintenance)	max 6	Color of Housing	White Body + Opal Cover
Beam angle	115	Materials (housing)	PC
Flicker metric	<1		
Stroboscopic effect metric	<0.4		

Parameters below are specific for each of the product codes:

Product code	Description	ELECTRICAL DATA			PHOTOMETRICAL DATA			DIMENSIONS & WEIGHTS	
		Luminaire power (W)	Light source On-mode power (W)	Dimmable	Luminaire lumen (lm)	Light source Useful lumen (360°) (lm)	Luminaire Efficiency (lm/W)	Dimensions (LxWxH) (mm)	Product weight (kg)
<b>STANDARD</b>									
93120923	LED MARINER ST G2 TU 2' 12W 840 S	12	12	No (Static)	1400	1400	116	72x600x58	1,3
93120924	LED MARINER ST G2 TU 2' 12W 865 S	12	12	No (Static)	1400	1400	116	72x600x58	1,3
93120925	LED MARINER ST G2 TU 2' 22W 840 S	22	22	No (Static)	2650	2650	110	72x600x58	1,6
93120926	LED MARINER ST G2 TU 2' 22W 865 S	22	22	No (Static)	2650	2650	110	72x600x58	1,6
93120927	LED MARINER ST G2 TU 4' 22W 840 S	22	22	No (Static)	2650	2650	110	72x1200x58	1,4
93120928	LED MARINER ST G2 TU 4' 22W 865 S	22	22	No (Static)	2650	2650	110	72x1200x58	1,4
93120931	LED MARINER ST G2 TU 4' 46W 840 S	46	46	No (Static)	5800	5800	121	72x1200x58	3,2
93120941	LED MARINER ST G2 TU 4' 46W 865 S	46	46	No (Static)	5800	5800	121	72x1200x58	3,2
93120929	LED MARINER ST G2 TU 5' 28W 840 S	28	28	No (Static)	3400	3400	120	72x1500x58	3,2
93120930	LED MARINER ST G2 TU 5' 28W 865 S	28	28	No (Static)	3400	3400	120	72x1500x58	3,2
93120942	LED MARINER ST G2 TU 5' 54W 840 S	54	54	No (Static)	6600	6600	117	72x1500x58	3,9
93120932	LED MARINER ST G2 TU 5' 54W 865 S	54	54	No (Static)	6600	6600	117	72x1500x58	3,9
<b>DIRECT SHIPMENT</b>									
93120867	LED MARINER ST G2 TU 2' 12W 840 S DS	12	12	No (Static)	1400	1400	116	72x600x58	1,3
93120868	LED MARINER ST G2 TU 2' 12W 865 S DS	12	12	No (Static)	1400	1400	116	72x600x58	1,3
93120869	LED MARINER ST G2 TU 2' 22W 840 S DS	22	22	No (Static)	2650	2650	110	72x600x58	1,6
93120870	LED MARINER ST G2 TU 2' 22W 865 S DS	22	22	No (Static)	2650	2650	110	72x600x58	1,6
93120871	LED MARINER ST G2 TU 4' 22W 840 S DS	22	22	No (Static)	2650	2650	110	72x1200x58	1,4
93120872	LED MARINER ST G2 TU 4' 22W 865 S DS	22	22	No (Static)	2650	2650	110	72x1200x58	1,4
93120875	LED MARINER ST G2 TU 4' 46W 840 S DS	46	46	No (Static)	5800	5800	121	72x1200x58	3,2
93120939	LED MARINER ST G2 TU 4' 46W 865 S DS	46	46	No (Static)	5800	5800	121	72x1200x58	3,2
93120873	LED MARINER ST G2 TU 5' 28W 840 S DS	28	28	No (Static)	3400	3400	120	72x1500x58	3,2
93120874	LED MARINER ST G2 TU 5' 28W 865 S DS	28	28	No (Static)	3400	3400	120	72x1500x58	3,2
93120940	LED MARINER ST G2 TU 5' 54W 840 S DS	54	54	No (Static)	6600	6600	117	72x1500x58	3,9
93120922	LED MARINER ST G2 TU 5' 54W 865 S DS	54	54	No (Static)	6600	6600	117	72x1500x58	3,9

## Photometric data

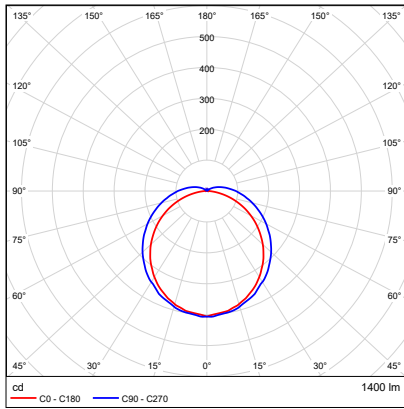

2' 12W

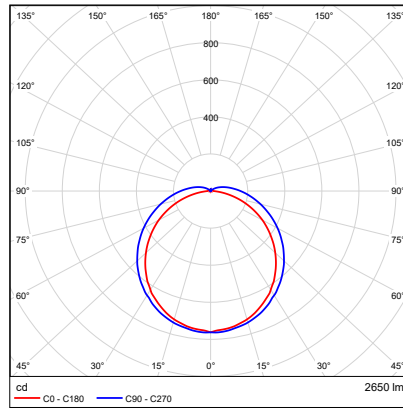

2' 22W

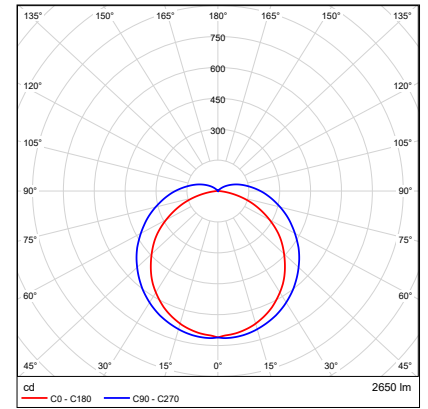

4' 22W

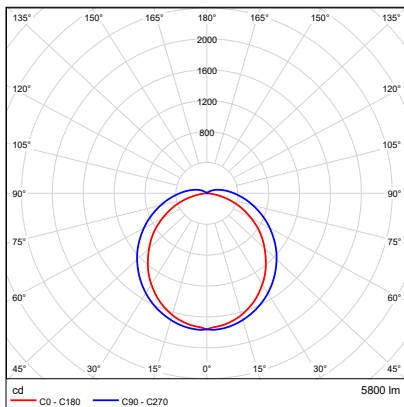

4' 46W

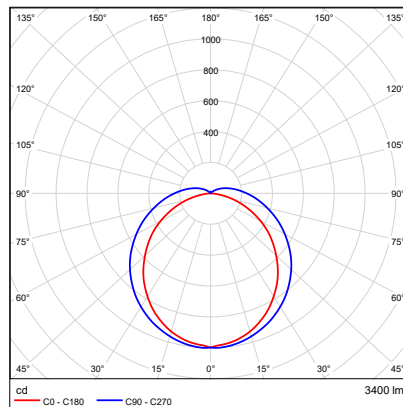

5' 28W

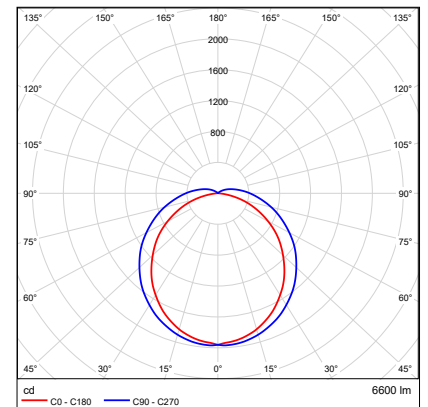

5' 54W

Only for indicative purpose. For lighting design, please use the ldt photometry files available for the products.

## Energy Class



## Dimensions (mm)

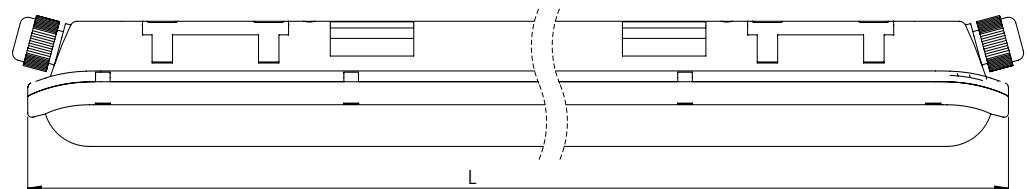
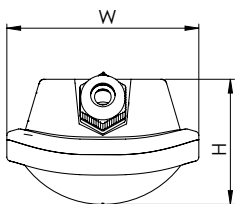

Length	Lumen package	Width (mm)	Length (mm)	Height (mm)
2ft = 600mm	low	72	600	58
2ft = 600mm	high	92	600	60
4ft = 1200mm	low	72	1200	58
4ft = 1200mm	high	92	1200	60
5ft = 1500mm	low	72	1500	58
5ft = 1500mm	high	92	1500	60

## Regulatory and standards

**Regulatory mark:** CE, UKCA, Morocco

**Regulations:** 2014/35/EU, 2014/30/EU, 2011/65/EU, (framework 2009/125/EC) EU 2019/2020, (framework EU/2017/1369) EU 2019/2015\*

Harmonized standards: EN 60598, EN 62493, EN 61547, EN55015, EN 61000, look for CE Declaration of Conformity and Technical File for more details. Photobiological risk assessment is maximum group 1. The product is considered safe, does not pose any photobiological hazard.

\*not on DOC

## Order logic

Internal Code	Range	Generation	Brand	Length	Wattage	CRI	CCT	Controller	Shipment
<b>LED Mariner</b>	<b>St</b> = Standard range	<b>G2</b> - Generation 2	<b>TU</b> - TUNGSRAM	2' - 2ft 4' - 4ft 5' - 5ft	<b>12W</b> <b>22W</b> <b>28W</b> <b>46W</b> <b>54W</b>	<b>8</b> - 80 CRI	<b>40</b> - 4000K <b>65</b> - 6500K	<b>S</b> - Static	<b>DS</b> - Direct Shipment